



52/2 Wexford Street Subiaco WA

2  2  2 

Indulge in the very best of Subiaco living with this stunning two-level, two-bedroom, two-bathroom fully renovated apartment, perfectly positioned atop the sought-after Emporium complex. Showcasing contemporary design, generous proportions and modern finishes, this residence offers a premium lifestyle just moments from shops, restaurants and public transport.

The open plan kitchen, dining and living area flows seamlessly onto a wide balcony. A well-appointed kitchen, excellent storage options (including additional storage space beneath the staircase), and thoughtfully designed interiors enhance both comfort and functionality. Set amongst beautifully maintained communal gardens, this apartment delivers a peaceful retreat while remaining right

Type : Apartment
Price : Offers Over \$990,000
Land Size : 150 sqm
View : <https://www.networkexchange.com.au/sale/wa/western-suburbs/subiaco/residential/apartment/8683801>



Mimma Notaro
08 9388 3335

[For full version visit the website](#)

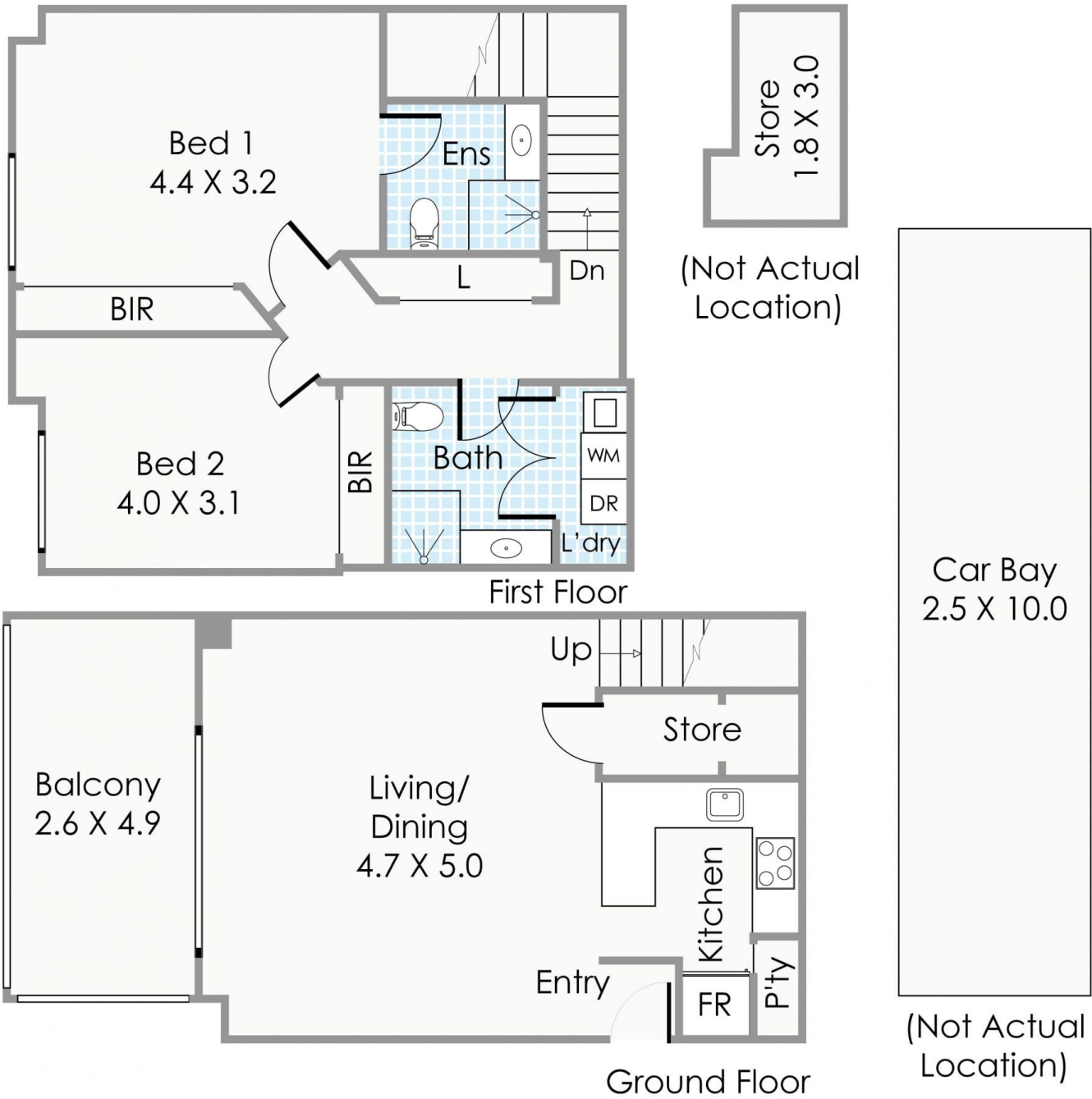

Approximate Areas

GROUND FLOOR

Residence:	47m ²
Car Bay:	27m ²
Balcony:	16m ²
Store:	5m ²

FIRST FLOOR

Residence:	55m ²
Total Area:	150m ²

Gabriella Verdiglione: 0423485918 Mimma Notaro: 0404042778

This floorplan is for illustration purposes only to show the layout of the property. Whilst every effort has been made to ensure the accuracy of this floor plan, all measurements, and any other information shown are an approximate interpretation only. Measurements and total areas do not include or account for wall thickness or roof area under eaves. Crib Creative will not be held liable or responsible for any error, omission, misrepresentation or use of any information shown on the final floor plan. Not to be used for any other purpose.
www.cribcreative.com.au



52/2 Wexford Street, Subiaco